

**JOYCE / SZERLIP
RESIDENCE**

55 STATE PARK ROAD
CHESTER,
NJ 07930

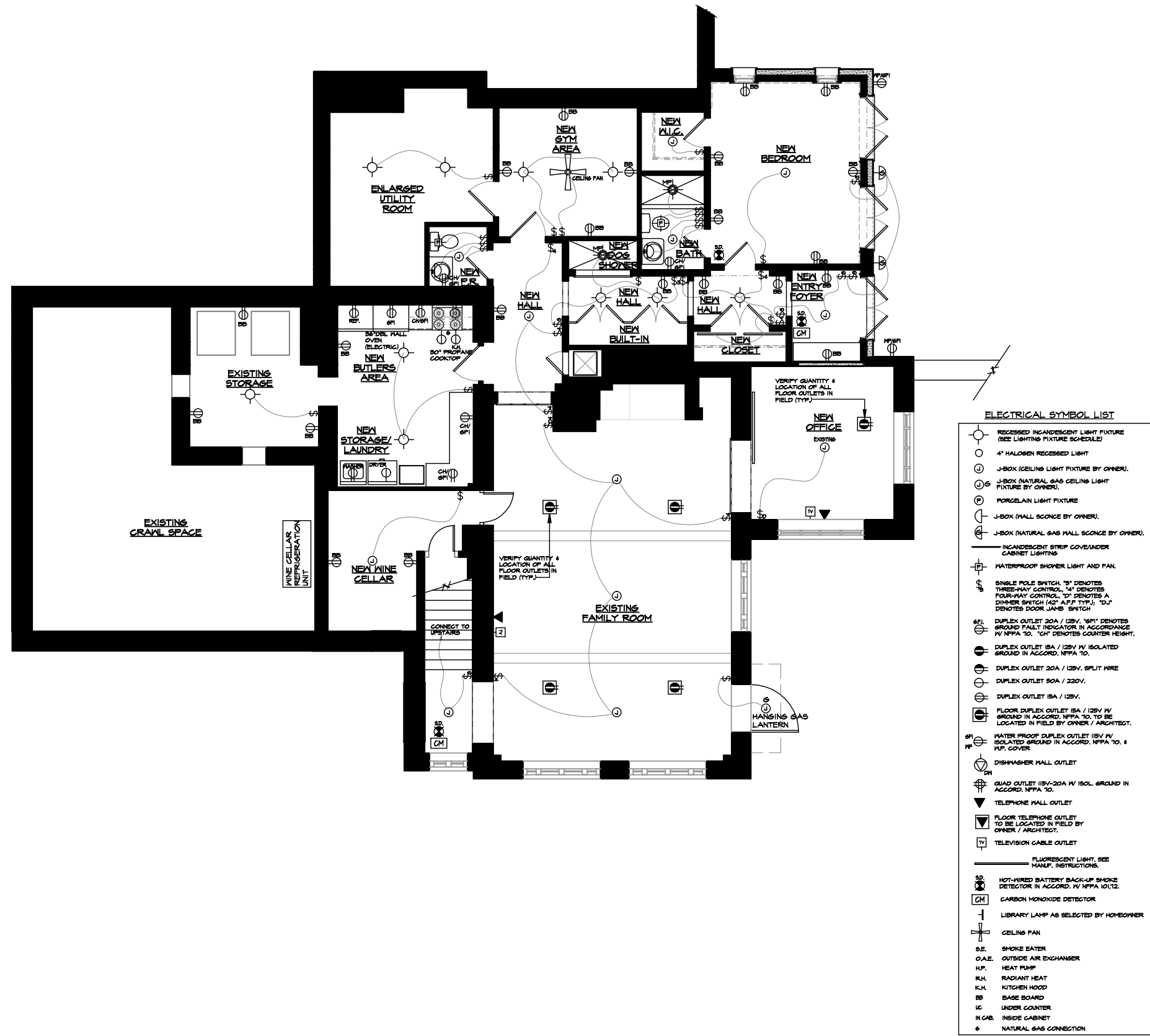

- ELECTRICAL SYMBOL LIST**
- ⊙ RECESSED INCANDESCENT LIGHT FIXTURE (SEE LIGHTING FIXTURE SCHEDULE)
 - 4" HALOGEN RECESSED LIGHT
 - ⊕ J-BOX (CEILING LIGHT FIXTURE BY OWNER)
 - ⊕⊕ J-BOX (NATURAL GAS CEILING LIGHT FIXTURE BY OWNER)
 - ⊕⊕ PORCELAIN LIGHT FIXTURE
 - ⊕ J-BOX (WALL SCONCE BY OWNER)
 - ⊕⊕ J-BOX (NATURAL GAS WALL SCONCE BY OWNER)
 - INCANDESCENT STRIP COVE/UNDER CABINET LIGHTING
 - ⊕ WATERPROOF SHOWER LIGHT AND FAN
 - ⊕ SINGLE POLE SWITCH 'S' DENOTES THREE-WAY CONTROL, '4' DENOTES FOUR-WAY CONTROL, 'D' DENOTES A DIMMER SWITCH (A2' A-FIP TYP.), 'D1' DENOTES DOOR JAMB SWITCH
 - ⊕ FL DUPLEX OUTLET 20A / 125V, '6P1' DENOTES GROUND FAULT INDICATOR IN ACCORDANCE W/ NFPA '10, 'CM' DENOTES COUNTER HEIGHT
 - ⊕ DUPLEX OUTLET 15A / 125V W/ ISOLATED GROUND IN ACCORD. NFPA '10
 - ⊕ DUPLEX OUTLET 20A / 125V, SPLIT WIRE
 - ⊕ DUPLEX OUTLET 30A / 220V.
 - ⊕ DUPLEX OUTLET 15A / 125V.
 - ⊕ FLOOR DUPLEX OUTLET 15A / 125V W/ GROUND IN ACCORD. NFPA '10, TO BE LOCATED IN FIELD BY OWNER / ARCHITECT.
 - ⊕ WATER PROOF DUPLEX OUTLET 15A W/ ISOLATED GROUND IN ACCORD. NFPA '10, & I.P.F. COVER
 - ⊕ DISHWASHER WALL OUTLET
 - ⊕ QUAD OUTLET 115V-20A W/ ISOL. GROUND IN ACCORD. NFPA '10.
 - ⊕ TELEPHONE WALL OUTLET
 - ⊕ FLOOR TELEPHONE OUTLET TO BE LOCATED IN FIELD BY OWNER / ARCHITECT.
 - ⊕ TELEVISION CABLE OUTLET
 - FLUORESCENT LIGHT, SEE MANUF. INSTRUCTIONS.
 - ⊕⊕ HOT-WIRED BATTERY BACK-UP SMOKE DETECTOR IN ACCORD. W/ NFPA 101/12.
 - ⊕⊕ CARBON MONOXIDE DETECTOR
 - LIBRARY LAMP AS SELECTED BY HOMEOWNER
 - ⊕ CEILING FAN
 - S.E. SMOKE EATER
 - O.A.E. OUTSIDE AIR EXCHANGER
 - H.P. HEAT PUMP
 - R.H. RADIANT HEAT
 - K.H. KITCHEN HOOD
 - BB BASE BOARD
 - UC UNDER COUNTER
 - IN CAB. INSIDE CABINET
 - ⊕ NATURAL GAS CONNECTION

REV.	DATE	ISSUE	REMARK
I	11.02.11	ISSUE	GENERAL REVISIONS
		REVISIONS	

JOB #
SET: G

BASEMENT ELECTRICAL PLAN

AS:TS HT
S.E.D. S.E.D.

HILAND HALL TURNER
NJ LIC. # 12074

HILAND HALL TURNER & ASSOCIATES P.A.
ARCHITECTS

3 CLARENCE ROAD, BIRCHDALE, NJ 07916 908-894-0302

E-01