

CHANGES AND ADDITIONS TO THE KANIA RESIDENCE

201 WASHINGTON AVENUE
CHATHAM, NEW JERSEY

| INDEX | DESCRIPTION | REV. DATE |
|-------|---------------------------------------|-----------|
| C-01 | Cover Sheet, Site Plan, Zoning Data | |
| A-01 | Demolition Plans | |
| A-02 | Foundation Plan | |
| A-03 | Basement Plan | |
| A-04 | First Floor Plan | |
| A-05 | Second Floor Plan | |
| A-06 | Third Floor Plan, Roof Plan | |
| A-07 | Front Elevation, Right Side Elevation | |
| A-08 | Rear Elevation, Left Side Elevation | |
| A-09 | Building Section, Door Schedule | |
| A-10 | Building Section, Window Schedule | |
| A-11 | Typical Wall Section | |
| A-12 | Electrical Plans | |
| A-13 | General Notes, Plumbing Riser Diagram | |

ZONING REQUIREMENTS
210 WASHINGTON STREET
CHATHAM BOROUGH, NJ
LOT 8, BLOCK 8
ZONE: R1
CONSTRUCTION TYPE: B5
SURVEY NOTE:
INFORMATION FOR SITE PLAN
TAKEN FROM
SURVEY PREPARED BY:
MURPHY & HOLLOWS
ASSOCIATES, INC.
881 ELM STREET
STIRLING, NJ
DATED: 6/19/2007

| | REQUIRED | EXISTING | PROPOSED | NOTES |
|--|---------------|--------------|-----------|---|
| MIN. LOT SIZE | 15,000 S.F. | 24,785 S.F. | NO CHANGE | EXISTING CONFORMING |
| LOT FRONTAGE | 100' | 100.44' | NO CHANGE | EXISTING CONFORMING |
| LOT WIDTH | 100' | 100.25' AVG. | NO CHANGE | EXISTING CONFORMING |
| LOT DEPTH | 100' | 252.82' | NO CHANGE | EXISTING CONFORMING |
| SETBACKS | | | | |
| FRONT YARD: | 32.25' | 67.44' | NO CHANGE | EXISTING CONFORMING |
| REAR YARD: | 48.68' | 141.02' | 122.1' | CONFORMING |
| SIDE YARD: MIN. | 15' (15%) | 14.77' | NO CHANGE | *EX'G. NON-CONFORMING / UNCHANGED |
| SIDE YARD: MIN. | 15' (15%) | 26.82' | NO CHANGE | EXISTING CONFORMING |
| MIN. COMBINED SIDE YARDS: | 50' (30%) | 41.54' | NO CHANGE | EXISTING CONFORMING |
| IMPROVED COVERAGE CALCULATIONS BASED ON 24,785 S.F. LOT: | | | | |
| MAXIMUM BUILDING COVERAGE | 2,587.1 S.F. | 1,715.8 S.F. | 2,585.5 | CONFORMING |
| MAXIMUM FLOOR AREA | 4,527.43 S.F. | 2,456.4 S.F. | 4,520.8 | CONFORMING |
| MAXIMUM LOT COVERAGE | 5,482.4 S.F. | 3,042.0 S.F. | 3,472.4 | CONFORMING |
| BUILDING HEIGHT | 35' MAX. | 32'-5" | NO CHANGE | EXISTING CONFORMING |
| | | | | *EXISTING HOUSE IS NON-CONFORMING TO SIDE SETBACK LIMIT |

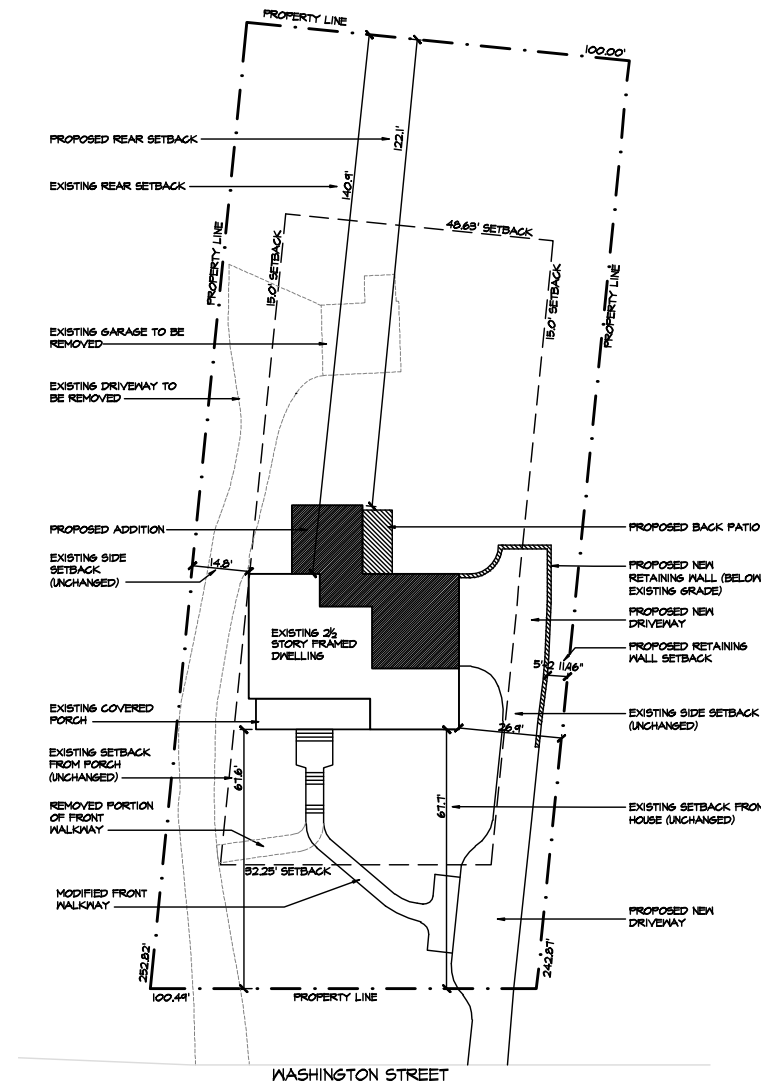

KANIA
RESIDENCE

201 WASHINGTON AVENUE
CHATHAM,
NJ 07928

| REV. DATE | ISSUE | REMARK |
|-----------|------------|--------|
| 12.06.15 | FOR FILING | |
| | | |
| | | |
| | | |
| | | |
| | | |
| | | |
| | | |
| | | |

JOB #
SET:
- TITLE & SHEET LIST
- ZONING DATA
- SITE PLAN

TS HT
DATE BY DATE BY
DATE BY DATE BY

HILAND HALL TURNER
NJ LIC. # 12074

HILAND HALL TURNER & ASSOCIATES P.A.
ARCHITECTS
2 CLAREMONT ROAD, BERNAARDSVILLE, NJ 07004 908-496-0772

C-01